

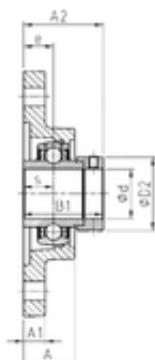

# NTN PRECISION AXLE CORP.



## SNR EXFL208 bearing units

Bearing No. EXFL208

Bore Diameter	40 mm
d	40 mm
e	21 mm
s	21,4 mm
A	36 mm
A1	14 mm
B1	56,3 mm
D2	60,3 mm
H	175 mm
J	144 mm
L	100 mm
N	16 mm
Thread (G)	M6x1
A2	55,9 mm
Weight	1,6 Kg
Basic dynamic load rating (C)	29,6 kN

EXFL208 Bearing 2D drawings and 3D CAD models